

Specifications

Nominal Voltage		12 V
Capacity (25°C)	10HR(10.8V)	34 Ah
	5HR(10.5V)	29.7Ah
	1HR(9.60V)	21.1Ah
Dimension	Length	310±2mm (12.2inch)
	Width	77±1mm (3.03inch)
	Height	166±2mm (6.54inch)
	Total Height	T2: 172±2mm (6.77inch) T3: 180±2mm (7.09inch)
Approx. Weight		9.5kg (20.9lbs)±4%
Terminal type		T2/T3
Internal resistance (Fully charged, 25°C)		Approx. 11mΩ
Capacity affected by temperature (10HR)	40°C	102%
	25°C	100%
	0°C	85%
	-15°C	65%
Self-discharge (25°C)	3 month	Remaining Capacity: 91%
	6 month	Remaining Capacity: 82%
	12 month	Remaining Capacity: 65%
Nominal operating temperature		25°C ± 3°C (77°F ± 5°F)
Operating temperature range	Discharge	-15°C ~ 50°C (5°F ~ 122°F)
	Charge	-10°C ~ 50°C (14°F ~ 122°F)
	Storage	-20°C ~ 50°C (-4°F ~ 122°F)
Float charging voltage(25°C)		13.50 to 13.80V Temperature compensation: -18mV/°C
Cyclic charging voltage(25°C)		14.50 to 14.90V Temperature compensation: -30mV/°C
Maximum charging current		10.2A
Terminal material		Copper
Maximum discharge current		200A(5 sec.)
Designed floating life(20°C)		12 years

- ◆ Absorbent glass mat technology;
- ◆ Recognized by UL & CE;
- ◆ ABS container.

Dimensions

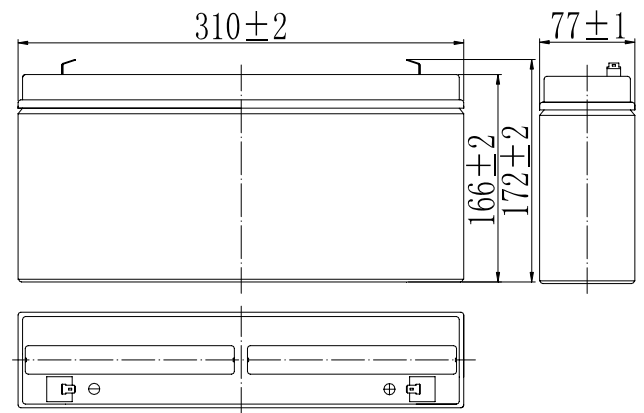

Terminal

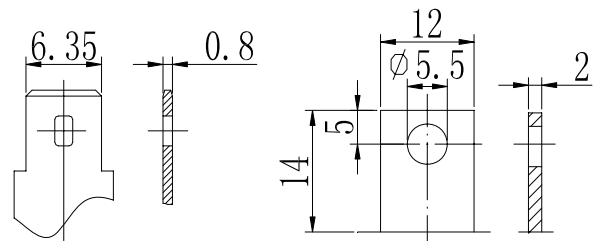

Terminal T2

Terminal T3

Constant Current Discharge Characteristics (A, 25°C)

F.V/TIME	15min	30min	60min	2h	3h	4h	5h	6h	8h	10h	20h
9.60V	--	34.0	21.1	12.4	8.67	7.11	6.07	5.31	4.16	3.46	1.82
9.90V	--	33.3	20.8	12.4	8.62	7.07	6.03	5.27	4.14	3.45	1.81
10.2V	--	32.3	20.2	12.2	8.56	7.02	5.99	5.24	4.11	3.44	1.81
10.5V	--	31.5	19.8	12.1	8.50	6.97	5.95	5.20	4.08	3.42	1.80
10.8V	--	30.4	19.2	11.8	8.25	6.76	5.77	5.05	3.96	3.40	1.79

Constant Power Discharge Characteristics (Watt, 25°C)

F.V/TIME	15min	30min	60min	2h	3h	4h	5h	6h	8h	10h	20h
9.60V	--	381	240	144	102	83.6	71.7	62.7	49.4	41.3	21.8
9.90V	--	374	237	143	101	83.1	71.3	62.3	49.1	41.2	21.8
10.2V	--	362	231	142	101	82.5	70.8	61.9	48.8	41.1	21.7
10.5V	--	354	226	140	100	82.0	70.3	61.5	48.5	40.9	21.6
10.8V	--	341	219	136	97.0	79.5	68.2	59.6	47.0	40.6	21.4

Note: The above characteristics data can be obtained within three charge/discharge cycles.

Discharge Characteristics(25°C)

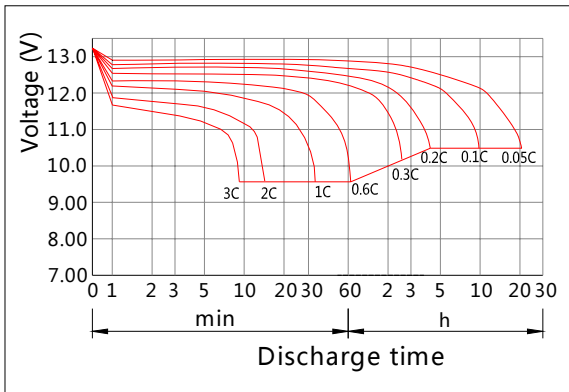

Charging Characteristics(25°C)

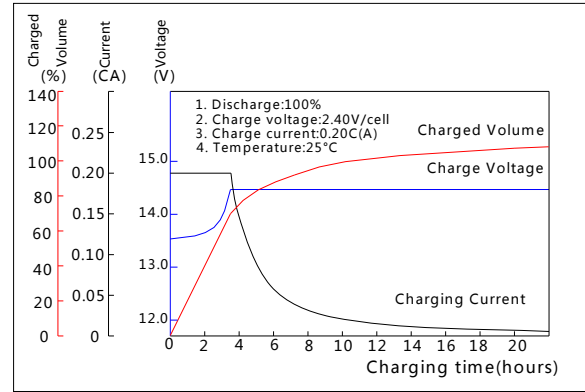

Effect of Temperature on Capacity

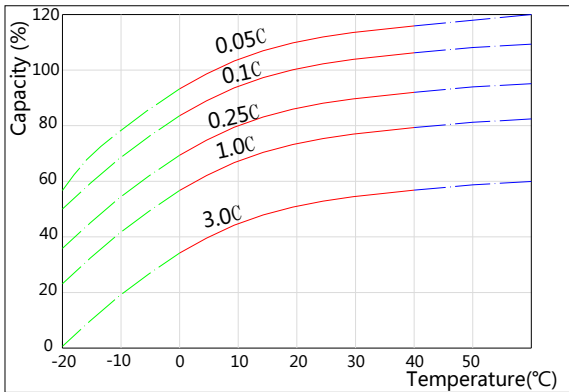

Self-discharge Characteristics

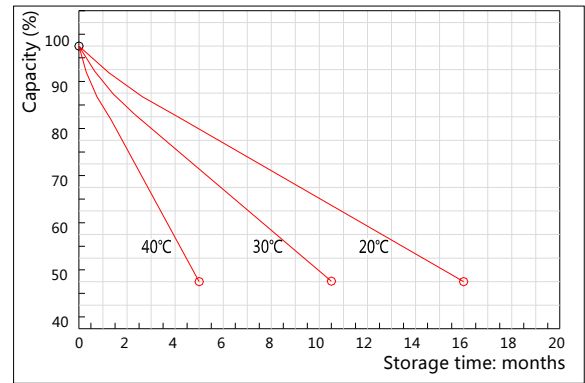

The Relationship for Open Circuit Voltage and Residual Capacity (25°C)

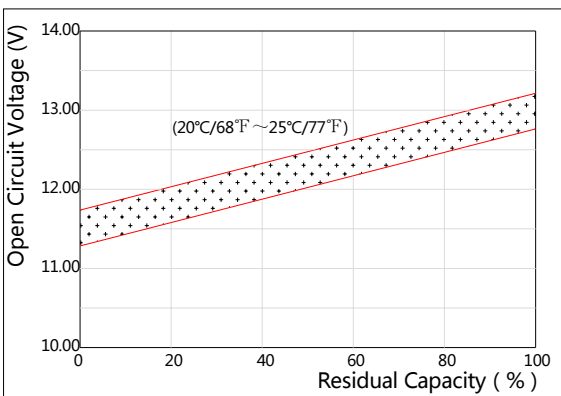

The Relationship for Charging Voltage and Temperature

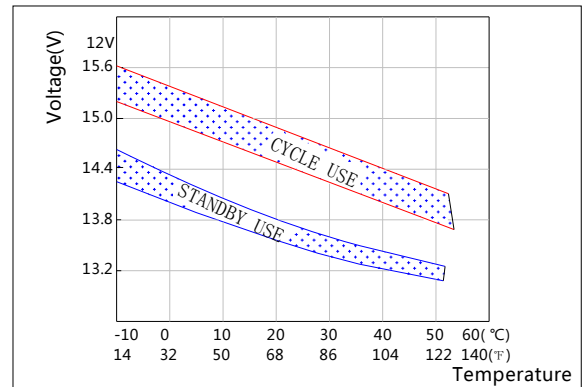

Floating Life on Temperature

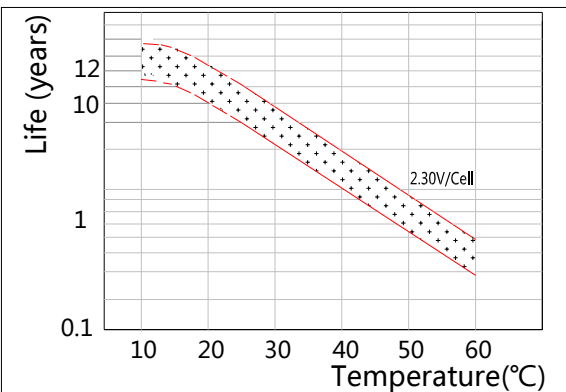

Cycle Life on D.O.D(25°C)

